

Welcome to the Public Open House!

L'Enfant Station and Fourth
Track Improvements Project

3:30 pm to 7:00 pm

Provide comments today!

*For more details and future project updates,
scan QR code or visit www.vre.org.*



Project Location

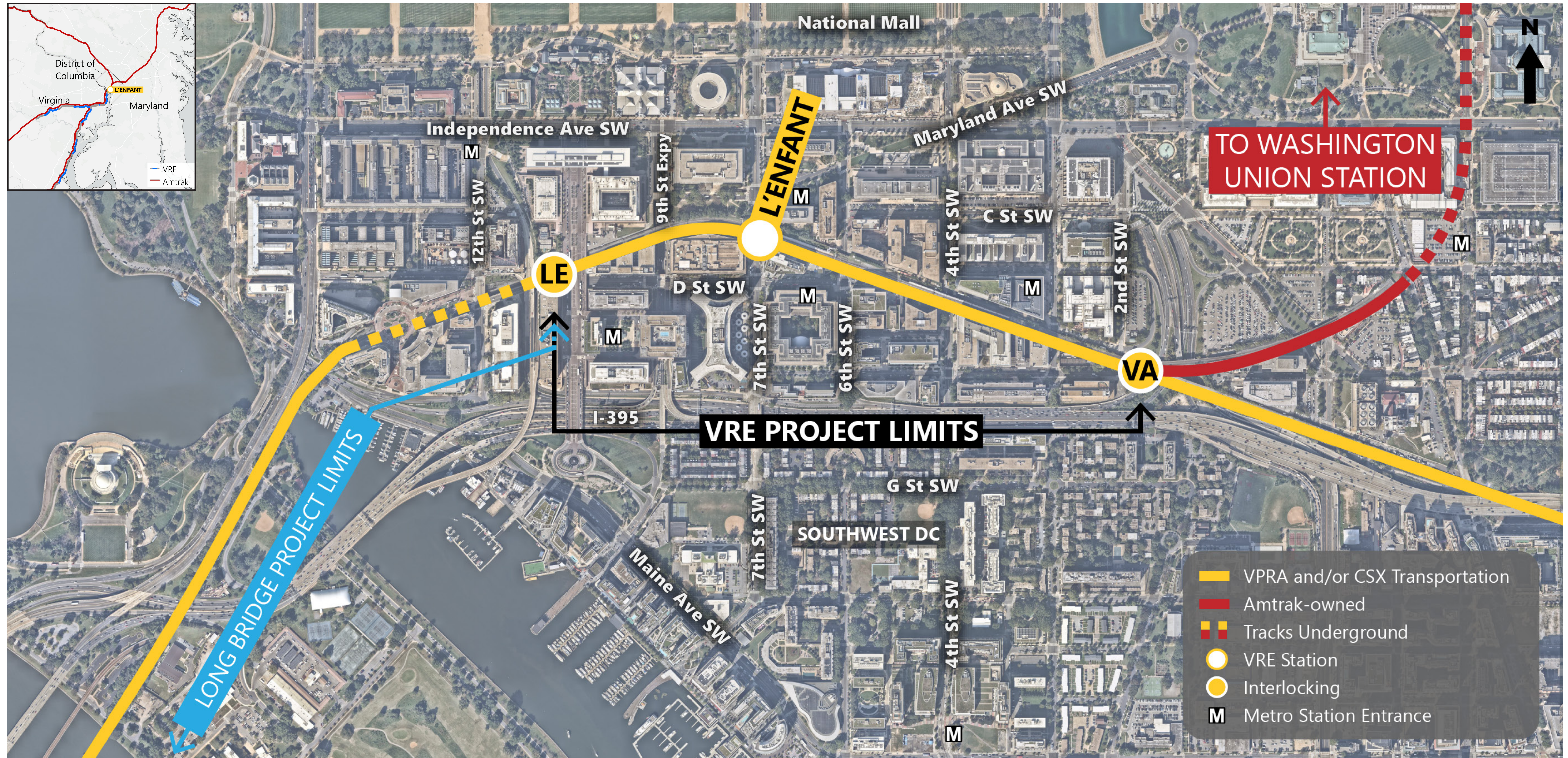

Why This Project



Existing Conditions and Constraints

- 3 existing tracks, shared by freight and passenger trains
- Station serves 1 train/direction at a time
- Platform too short for full 8-car train boarding
- Passenger crowding
- Dense urban area with heavily used infrastructure

Project Goals

- Increase rail capacity and reduce conflict between passenger and freight trains
- Allow 2 trains/directions at a time
- Accommodate longer trains and reduce crowding
- Remain within existing railroad right-of-way wherever possible
- Improve station accessibility with an elevator at each entrance and integrate the station with the surrounding community

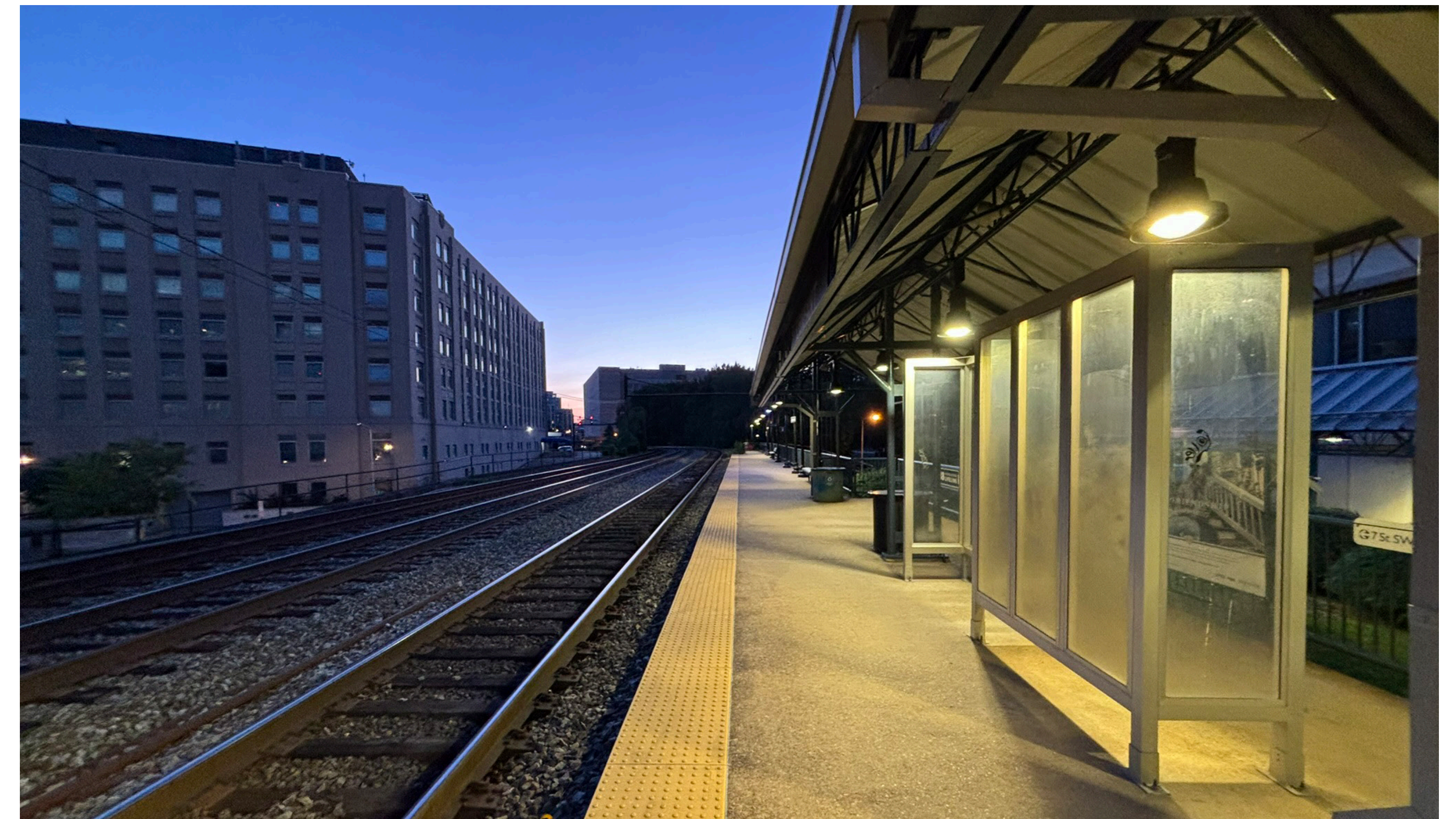

Project Timeline

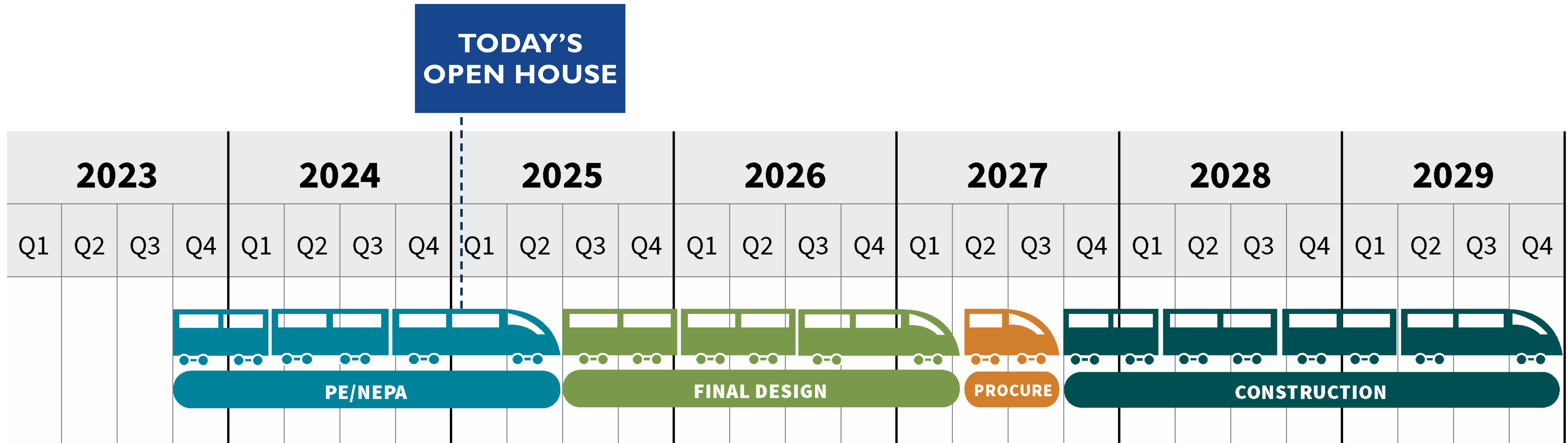

Next Steps

- Completion of NEPA Environmental Review and Preliminary Engineering: mid-2025
- Final Design: expected to begin 2nd half of 2025
- Construction: anticipated 2027 – 2029
- ▶ *Public engagement and stakeholder coordination will continue throughout the NEPA process and into final design.*
- ▶ *VRE is exploring construction options which could include alternative project delivery methods.*

7th Street SW Entrance

EXISTING CONDITION



PROPOSED CONDITION



PROPOSED CONDITION



600 Maryland Ave loading area
(Smithsonian office building)

**Renderings above are illustrative; future appearance or design elements may change in final design.*

- Removes existing VRE station stairs and ADA accessible ramp
- Connects street entrance to L'Enfant station platform through a proposed tunnel with elevator and stairs

- Expands existing bridge to the north to fit the fourth track
- Will match bridge design and appearance to the existing bridge

6th Street SW Entrance

EXISTING CONDITION



600 Maryland Ave loading area
(Smithsonian office building)

PROPOSED CONDITION



PROPOSED CONDITION



- Removes existing VRE station stairs
- Connects street entrance to L'Enfant station platform through a proposed tunnel with elevator and stairs
- Replaces existing bridge with new bridge to support expanded platform and fourth track

PROPOSED CONDITION



**Renderings above are illustrative; future appearance or design elements may change in final design.*

Station Platform

PROPOSED CONDITION



**Renderings above are illustrative; future appearance or design elements may change in final design.*

- Replaces existing side platform with center platform
- Connects platform to street entrances via elevators and stairs at either end
- Features benches, lighting, security cameras, and canopy with windowed skylights over stairs

PROPOSED CONDITION



PROPOSED CONDITION



Station and Track Design Details

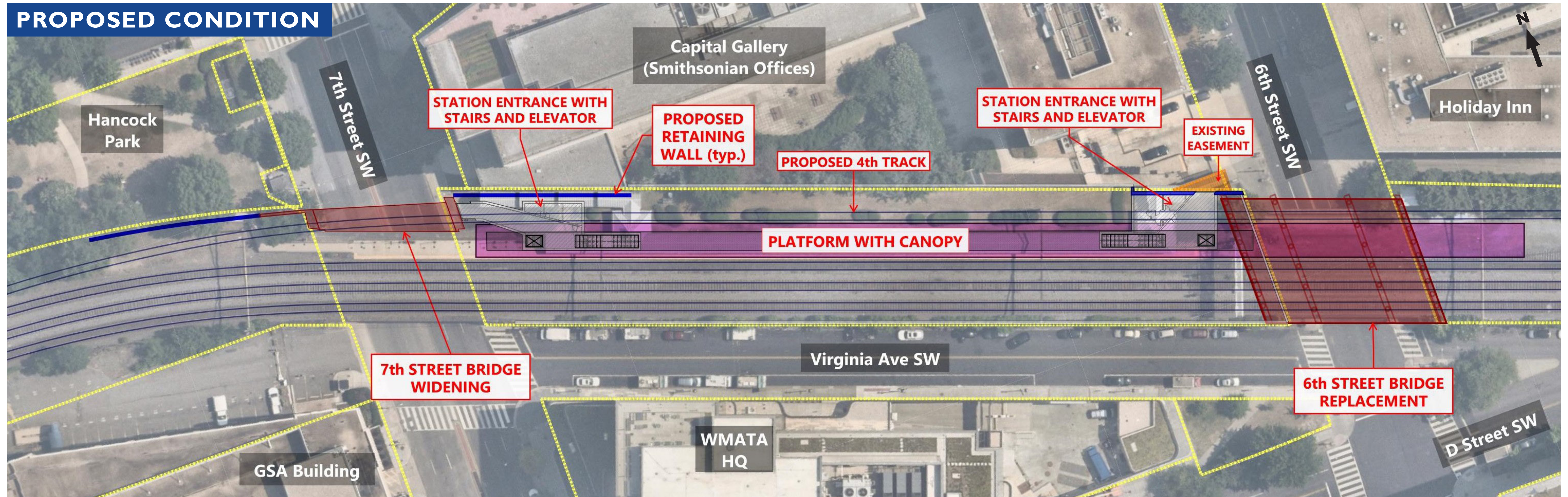

CROSS-SECTION: 7TH ST SW BRIDGE

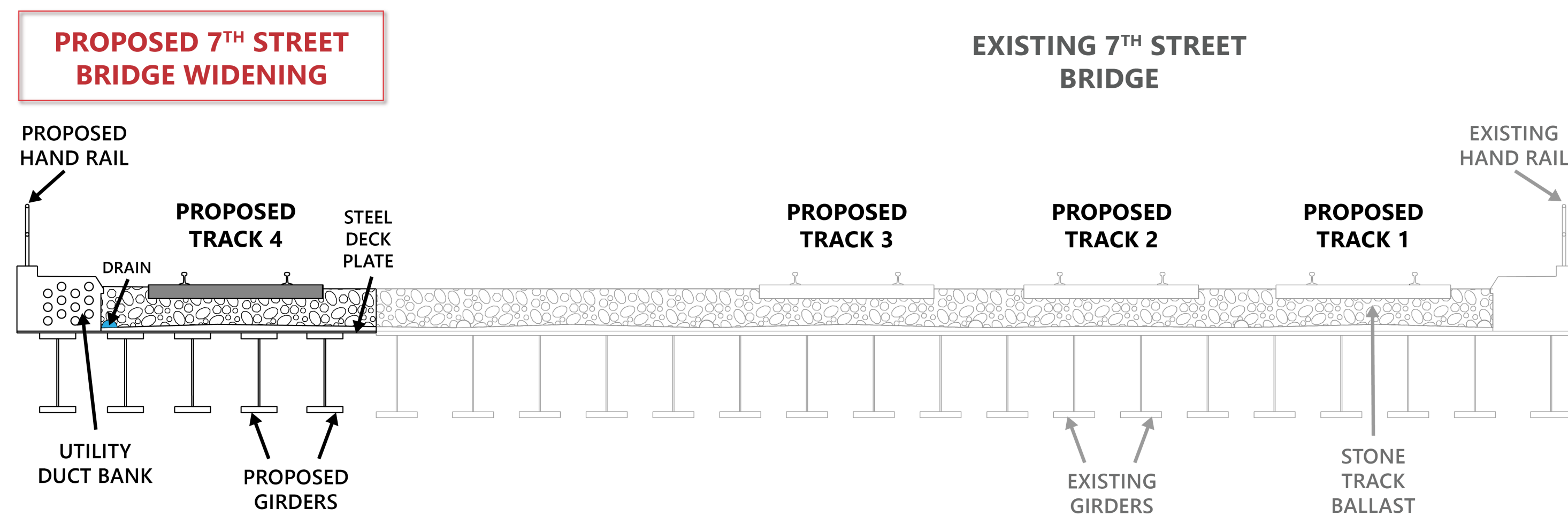

CROSS-SECTION: 6TH ST SW BRIDGE

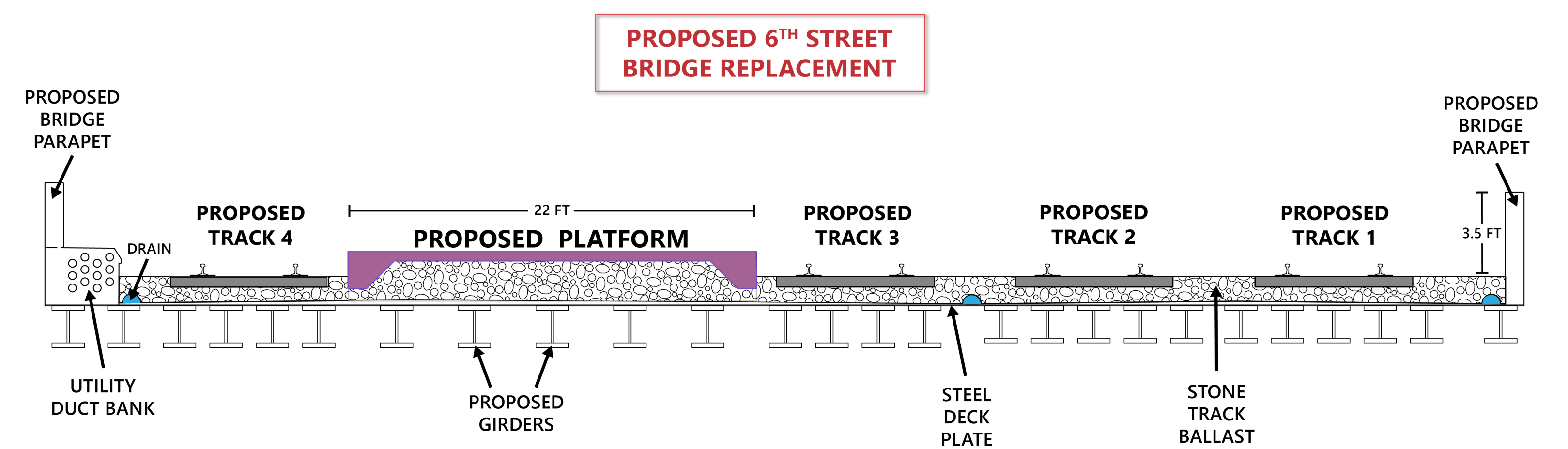

NEPA & Section 106 Process

The National Environmental Policy Act of 1969 (**NEPA**) requires assessment of the environmental impacts of proposed Federal actions before making final decisions on location, design, and construction.

Section 106 of the National Historic Preservation Act requires consultation with State Historic Preservation Offices, Tribes, and other parties in determining the potential effects of a project on historic properties within a defined area of potential effects (APE).

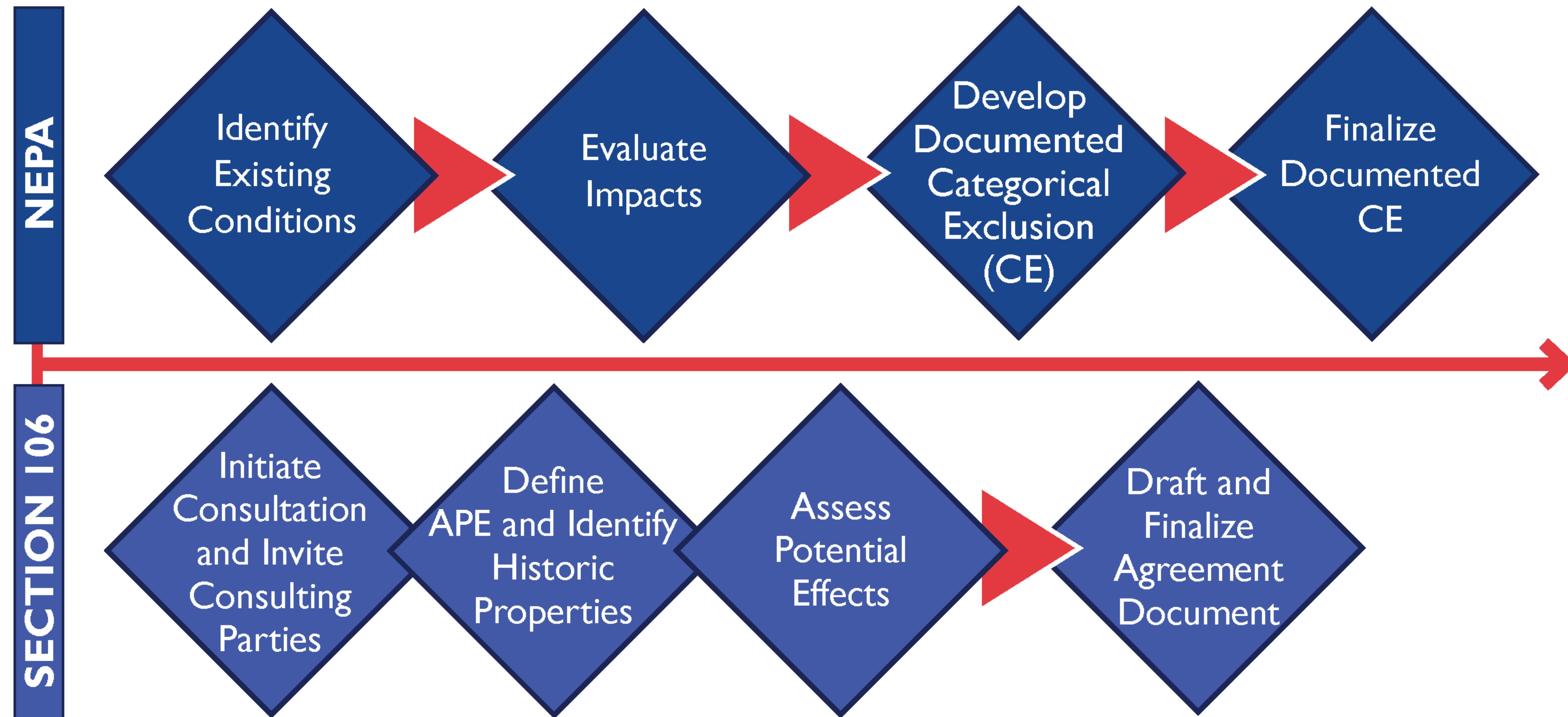

Environmental Resources

The National Environmental Policy Act (NEPA) of 1969 requires assessment of the environmental impacts of proposed Federal actions before making final decisions on location, design, and construction.

Resources of Interest:

- Noise and Vibration
- Traffic and Transportation
- Parks and Recreation Areas
- Aesthetics/Visual Quality
- Historic Resources (Section 106)

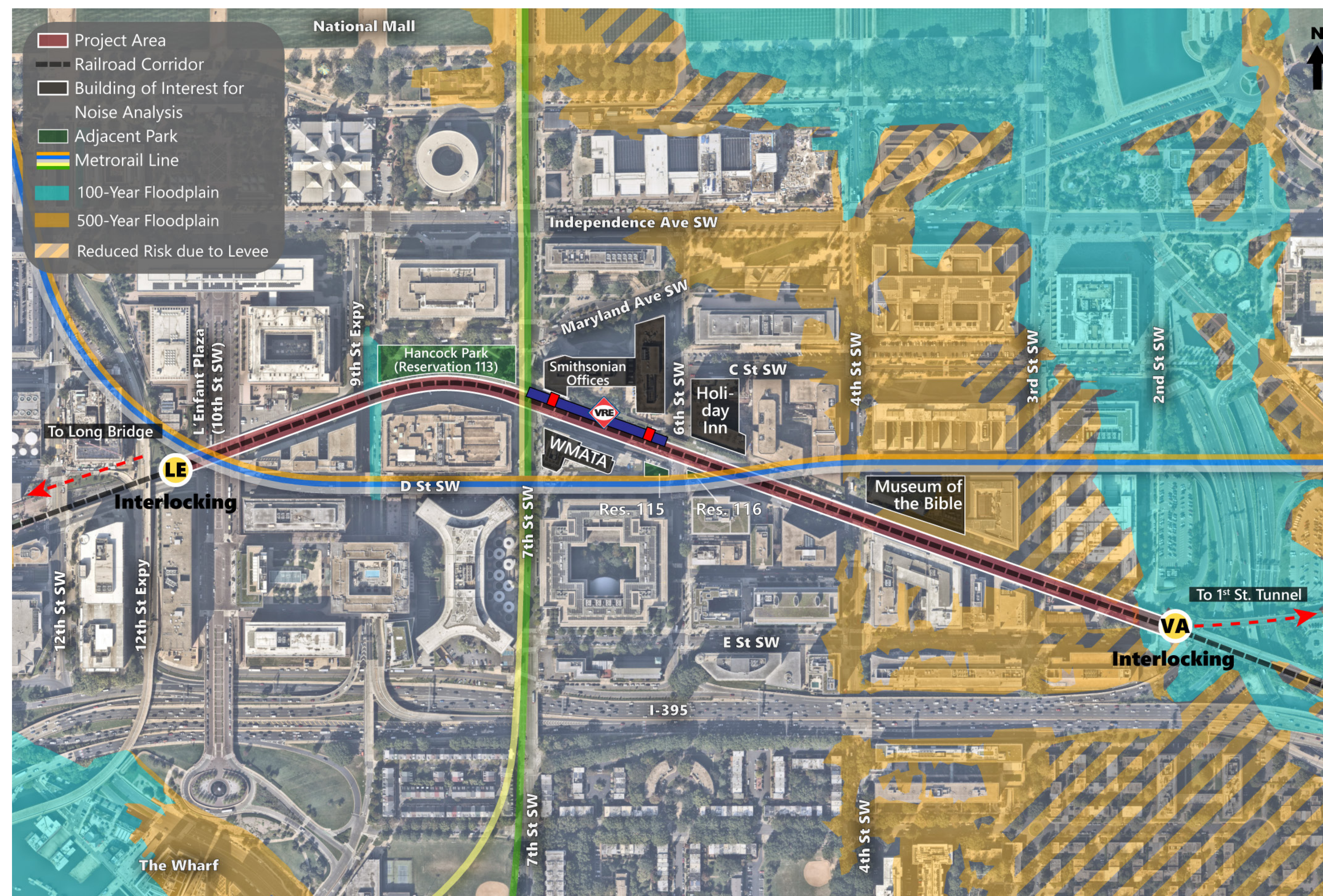

TREE IMPACTS

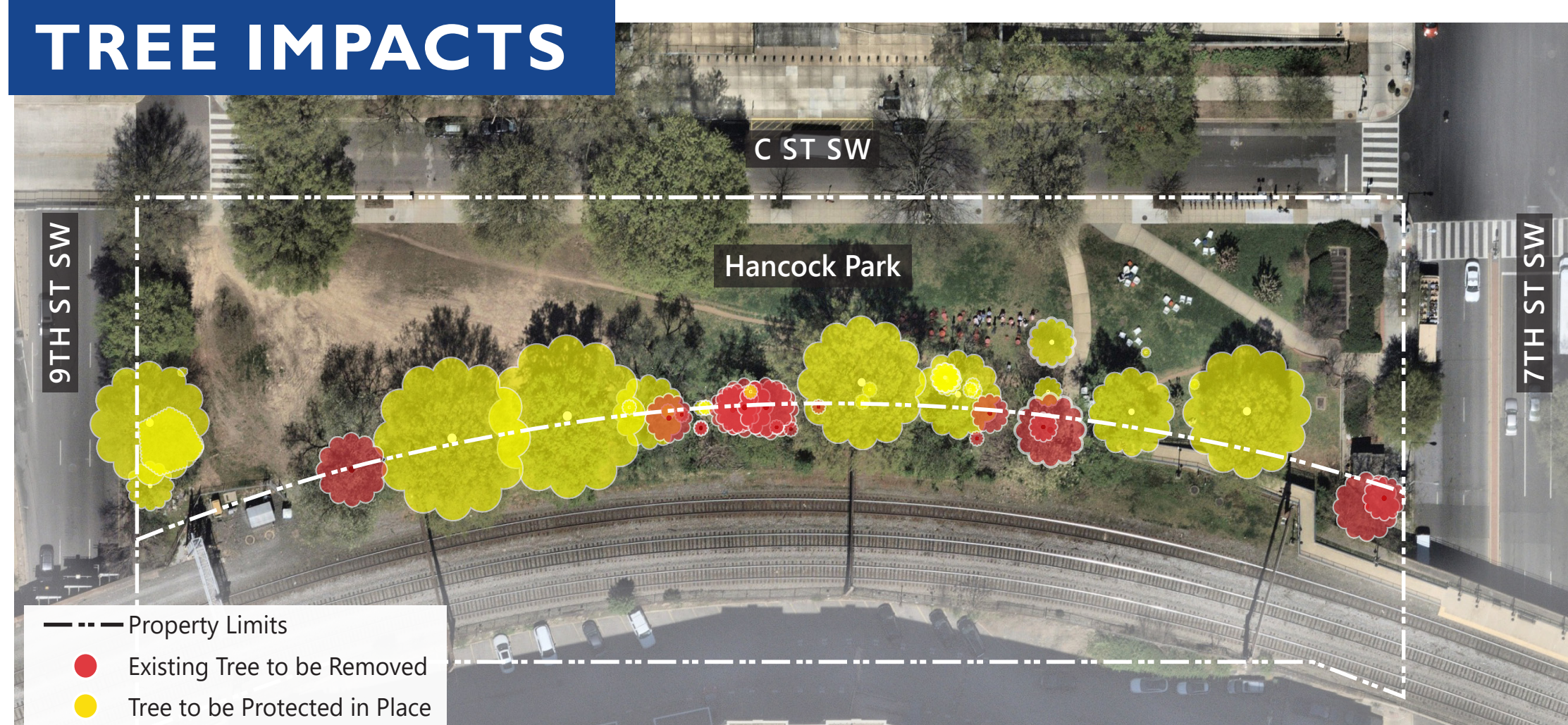

*All trees to be removed are within railroad right-of-way.

Section 106 Summary

Section 106 of the National Historic Preservation Act requires consultation with State Historic Preservation Offices, Tribes, and other parties in determining the potential effects of a project on historic properties.

- Identified proposed Area of Potential Effect (APE) and historic properties near L'Enfant Station
- Determined eligibility of 2 properties:
 - ▶ Baltimore & Potomac Railroad - Recommended Eligible
 - ▶ American Road Builders Association Building - Recommended not eligible
- Continuing coordination with the DC Historic Preservation Office and Consulting Parties

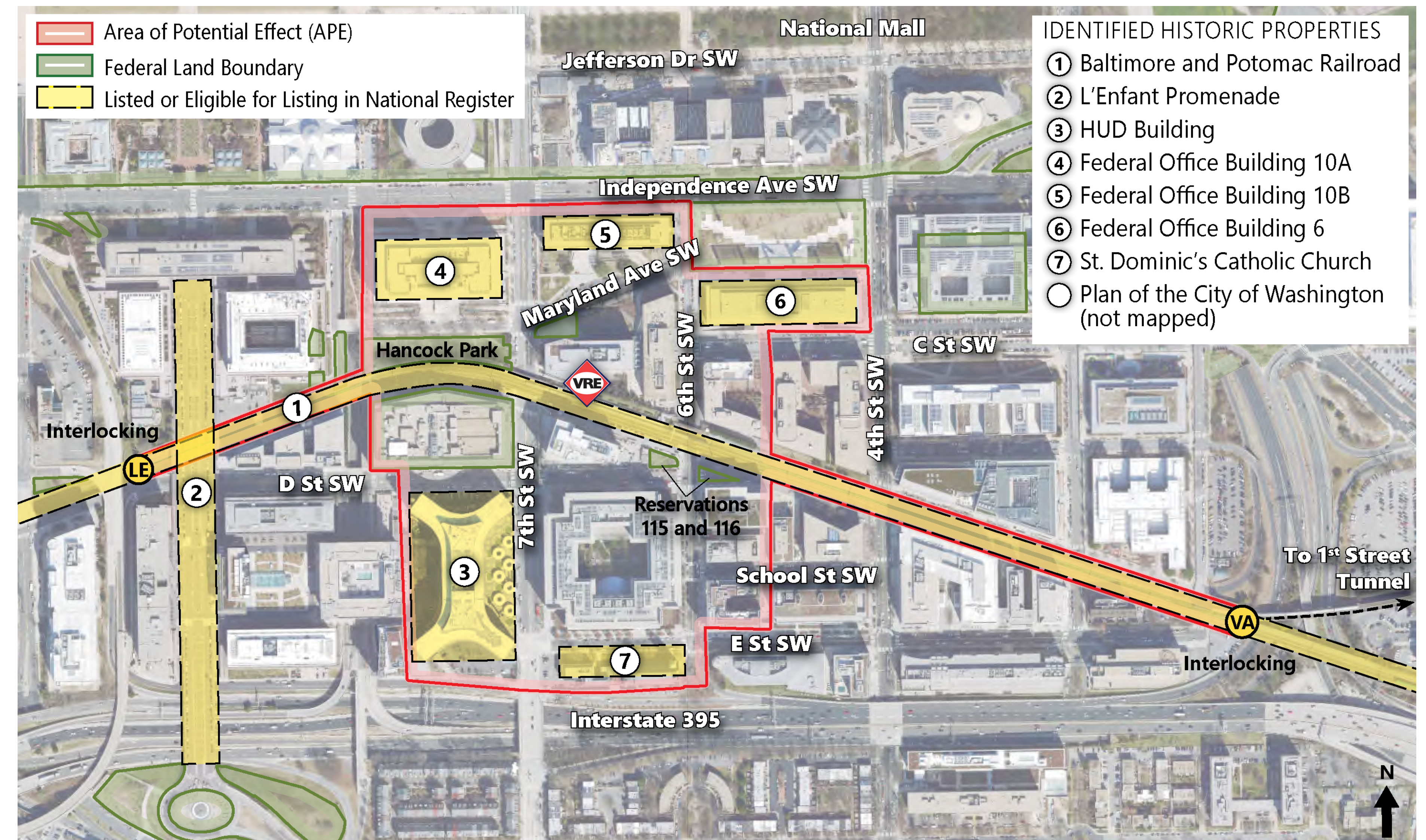

Construction Staging/Access

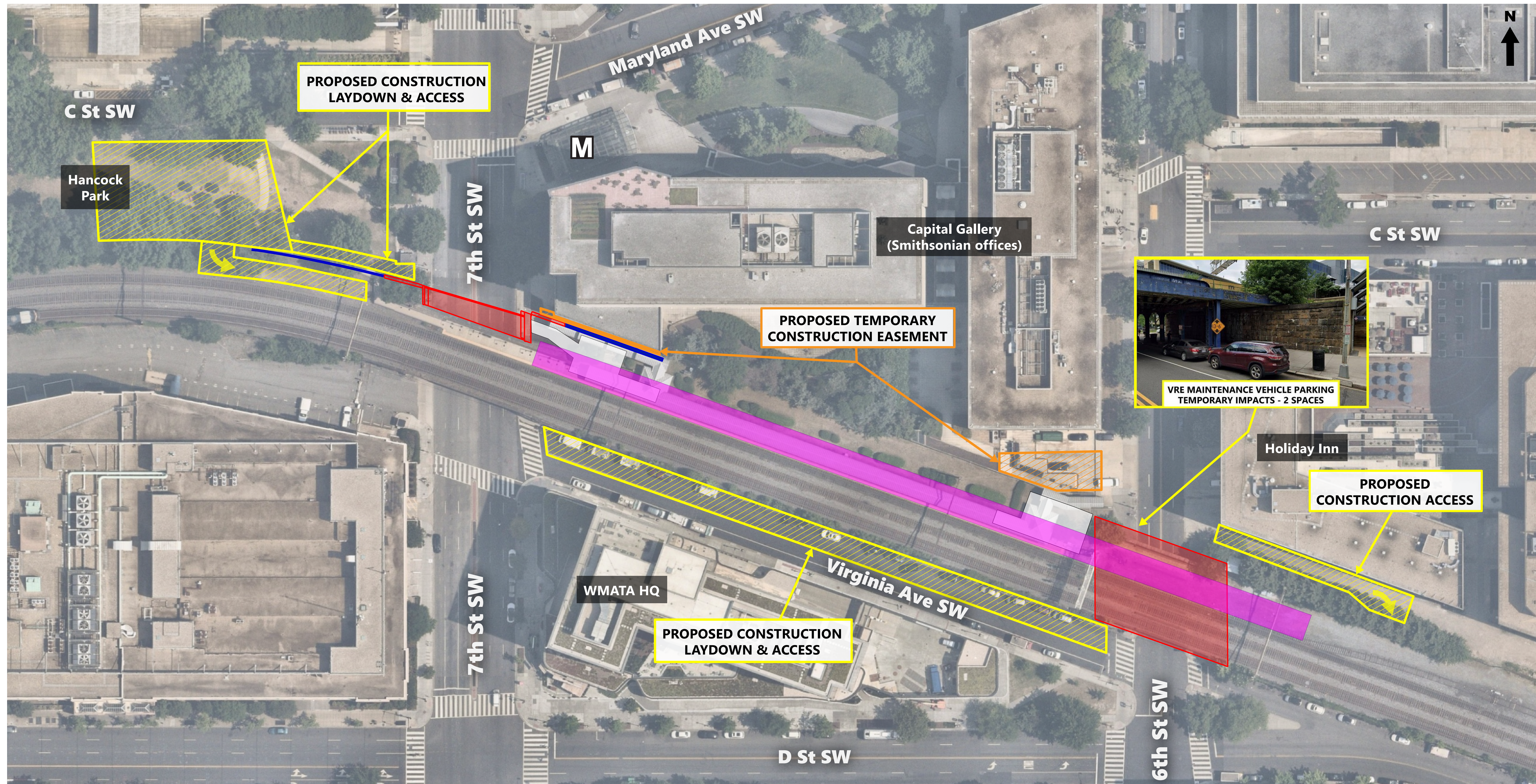

Hatched construction laydown/access area shown on Virginia Avenue SW to be coordinated with DDOT and adjacent property owners/stakeholders. Limits shown are preliminary, with any temporary street closures to be minimized where possible.

Stakeholder Engagement

Working Group Members

- Advisory Neighborhood Commission 6D
- Amtrak
- Commission of Fine Arts
- Committee of 100 on the Federal City
- CSXT
- DC Office of Planning
- Virginia Department of Rail and Public Transportation
- District Department of Energy and Environment
- District Department of Transportation
- DC Historic Preservation Office
- Federal City Council
- Federal Railroad Administration
- Federal Transit Administration
- General Services Administration
- Greater Washington Partnership
- National Capital Planning Commission
- National Park Service

- NPS National Mall and Memorial Parks
- Northern Virginia Transportation Commission
- Potomac and Rappahannock Transportation Commission
- Smithsonian Institution
- Southwest Business Improvement District
- Southwest Neighborhood Assembly
- Virginia Passenger Rail Authority
- Washington Metropolitan Area Transit Authority
- Nearby property owners

WORKING GROUP MEETINGS

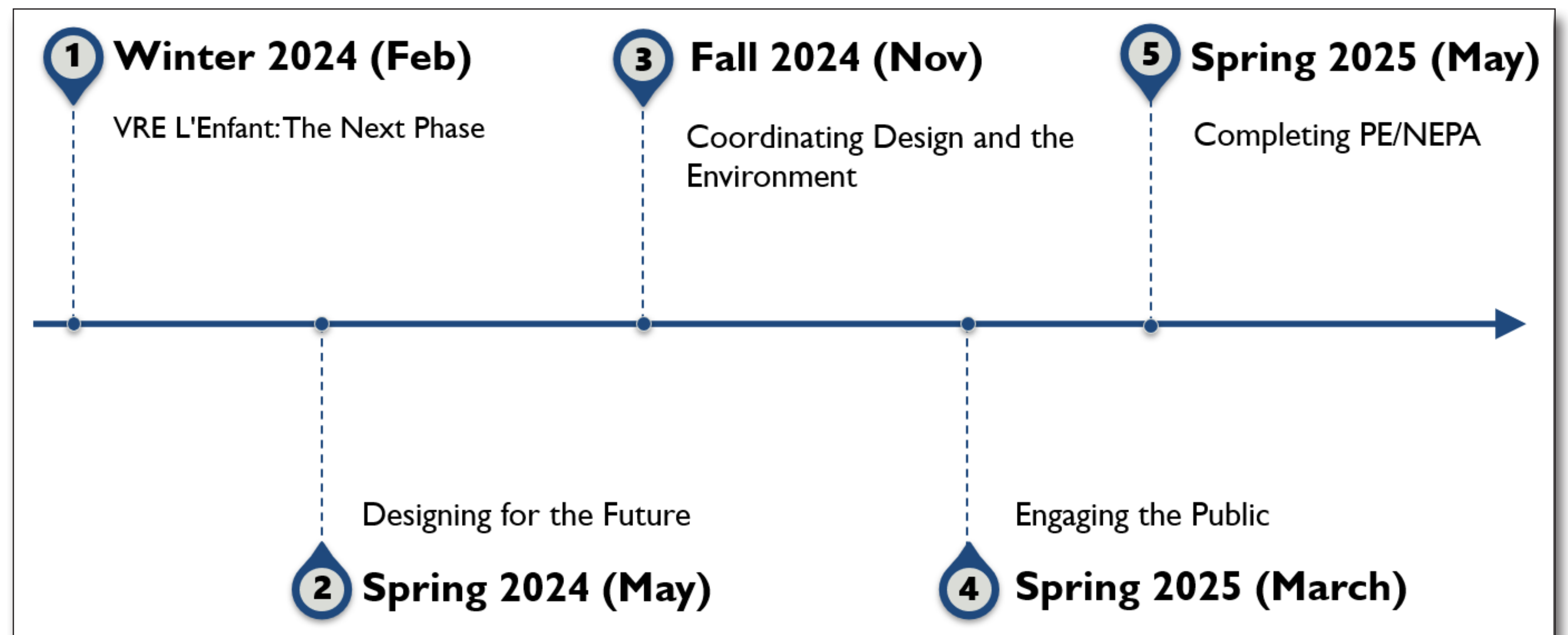

How To Give Feedback

**LEAVE A COMMENT
HERE TODAY!**

Share your questions, ideas, and concerns today! You can talk to our staff, fill out a comment card, or add a sticky note below.

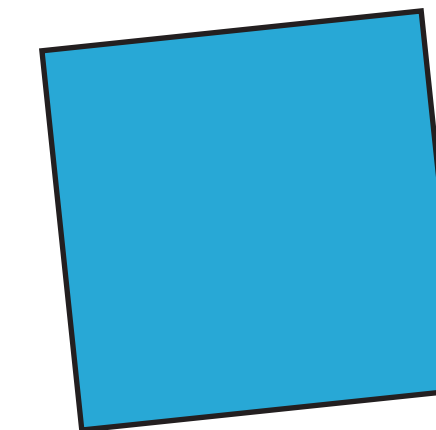
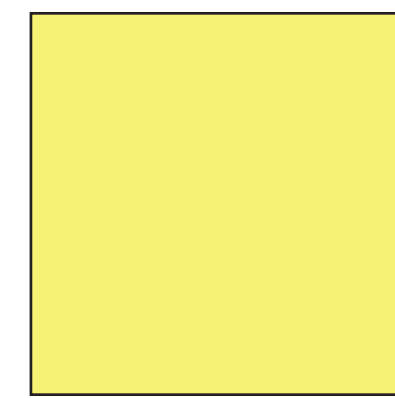

Email comments to:
dshikurye@vre.org

...Or mail comments to:
Virginia Railway Express (VRE)
Attention: LEF/Dagmawie Shikurye
1500 King St., Suite 202
Alexandria, VA 22314

For more details and future project updates, scan QR code or visit:
www.vre.org/projects/details/?ProjectId=21

